

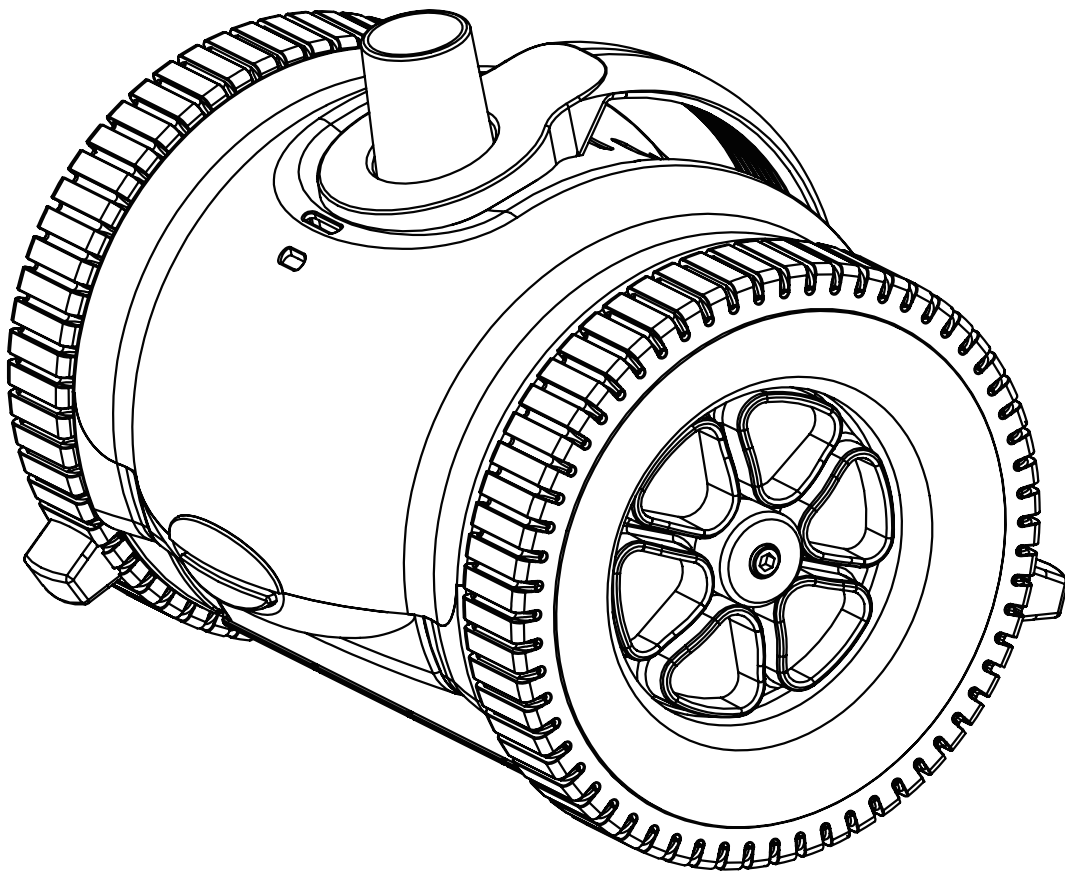

GLIDE

POOL CLEANER



INSTALLATION & OPERATION MANUAL

HY-CLOR AUSTRALIA PTY LIMITED
ABN: 81 000 655 381

178 Power Street
Glendenning NSW 2761 Australia

All enquiries
AU: 1800 625 123 NZ: (09) 973 2477
or help@hyclor.com.au

Visit us at hyclor.com.au

Version 2.2



PRODUCT HELPLINE

**AU: 1800 625 123
NZ: (09) 973 2477**

**help@hyclor.com.au
www.hyclor.com.au**

Glide Pool Cleaner

Installation and Operation Manual

SAFETY & WARNINGS:	4
PRIOR TO INSTALLATION:	5
PARTS LIST:	6
INSTALLATION STEPS 1-3:	6-13
HOSE FLOATS:	8
SKIMMER CONNECTION:	9
FINE TUNING THE CLEANER:	10
RETURN EYEBALL POSITIONS:	11
HOW TO USE THE FLOW-METER:	12
ROUTINE MAINTENANCE:	12
CARING FOR YOUR CLEANER:	13
USING THE BUMPERS (if required):	14
REPLACING TYRES:	14
TROUBLESHOOTING:	15-16
GLIDE BREAKDOWN:	17
WARRANTY:	18

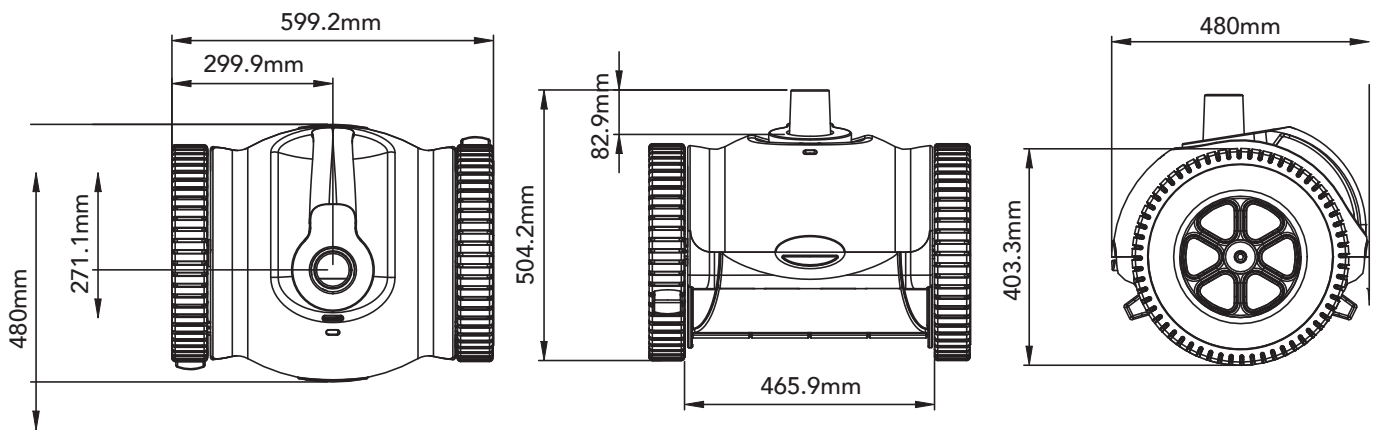

PRODUCT HELPLINE

AU: 1800 625 123
 NZ: (09) 973 2477

help@hyclor.com.au
 www.hyclor.com.au



SAFETY INSTRUCTIONS: READ PRIOR TO USE

SUCTION AND DROWNING RISKS

If your pool is equipped with one, you **MUST** cover your dedicated suction port/vac port/ automatic pool cleaner port when not in use by the cleaner.

DO NOT allow anyone, especially children, to use or play with or around the cleaner or hose. Educate the pool users about the dangers of the hose, cleaner, and suction ports.

DO NOT play with cleaner or apply cleaner or hose to body, clothing or hair. The hose and cleaner can take hold of your body, hair, or clothing and cause serious injury. The suction from the hose or cleaner can trap a swimmer underwater. **NEVER ALLOW ANYONE TO ENTER THE POOL** when the cleaner is in use.

MOVING PARTS

STOP PUMP before swimming. The moving pool cleaner, hose and suction ports can injure or entrap swimmers.

STOP PUMP the cleaner must be completely disabled by turning off the pool's pump and suction before cleaning or maintaining the cleaner. Moving parts and suction can injure fingers or body.

STOP PUMP, detach hose, and move the cleaner and hose to an unused corner of the pool. If the hose interferes with the swimmers, remove it from the pool.

CHILD DROWNING RISK

Adult use only. Never allow children to use the Glide pool cleaner. Educate all pool users about the dangers of the hose, cleaner and suction ports. Store out of reach of children. Keep away from pets.

CONGRATULATIONS

Congratulations on your purchase of the Glide pool cleaner. Your new cleaner can work in different types and sizes of swimming pools. It will be able to partially climb the walls. The Glide has an encased drive train to reduce the risk of the turbines jamming on debris. The Glide pool cleaner will do an excellent job of cleaning your pool with little to no supervision required.

PRIOR TO INSTALLATION

Carefully read and follow all instructions contained in this operating manual. Failure to do so may cause injury, inhibit the operation of the pool cleaner, or damage your pool. Hyclor disclaims any liability for repairs or replacements to any structures or components in the customer's pool.

The cleaner was not designed to be used as the first clean after pool construction or at the beginning of the season. The Pool Surface must be in good condition and must be cleaned of algae and debris prior to the cleaner's first use.

The GLIDE POOL CLEANER is compatible with all surfaces. However, users with vinyl pools should be mindful of their pool's construction and potential issues, and they need to maintain the pool surface well. For users with fiberglass pools, it's important to note that the cleaner will primarily clean the pool floor only.

The entire filter system must be cleaned prior to installation. Clean the filter, empty, backwash and rinse all baskets, as the cleaner will not operate properly with a dirty or clogged filter system. Carefully follow the steps for preparing your pool before installing the cleaner.

PREPARING YOUR POOL

Before installing your Glide Pool Cleaner, you need to prepare your pool as the Glide pool cleaner will not operate unless the filter system is clean and ready for use.

1. Vacuum your pool using a manual vacuum cleaner. Your pool should be free of heavy debris & algae prior to first use. It is not meant for initial pool start-up or opening after winter or long periods of time.
2. Make sure the chemical balance of your pool water is correct: Chlorine at or below 3ppm and PH between 7.2 and 7.8.
3. Brush your pool and let any debris settle.
4. Clean your pool filter, skimmer basket and pump strainer basket.
5. Close the pool main drain (if your pool has one).

TIPS FOR USAGE

Your pool must be in good condition for proper use of this cleaner. If there are broken tiles, crumbling plaster/concrete, or similar damage, using the cleaner could cause further damage to your pool or to the cleaner itself. Additionally:

- The cleaner is not designed to clean steps, waterfalls, or ladders, so these areas will require manual cleaning with a brush.
- When removing the cleaner from the pool, ensure the hose is stored straight. If the hose becomes coiled, lay out the hose sections in sunlight to straighten them.
- Do not allow the cleaner to run under a pool cover.
- Remove your Glide pool cleaner (including hose) before chemical treatment. Wait at least 4 hours after super chlorination (shock treatment) before reinstalling the Glide. The cleaner does not replace chemical treatment, so continue to treat your pool as needed.
- Algae growth can prevent the cleaner from working correctly and climbing walls.
- Clean the filter, skimmer basket and pump basket regularly.
- Periodically check your Glide for signs of wear, and replace any worn parts as necessary.

3.0 INSTALLING YOUR GLIDE POOL CLEANER

Your Glide Pool Cleaner is comes assembled, making installation quick and simple.

STEP 1: CHECK CONTENTS

Remove the cleaner body and all accessories from the box and check the contents. Refer to **Figure 1**.

No.	Glide cleaner head	Qty
1	Head Cleaner	1
2	Hose Lengths	14
3	Leader Hose	1
4	Flow Gauge (Flow - Meter)	1
5	Hose Float	2
6	Control Valve Adaptor (Hose Cone)	1
7	Flow Control Valve (Regulator Valve)	1
8	Female / Female Hose	1
9	45° Adaptor Elbow	2
10	Tyre Bumpers	2

Note: The Glide uses APC styled hoses

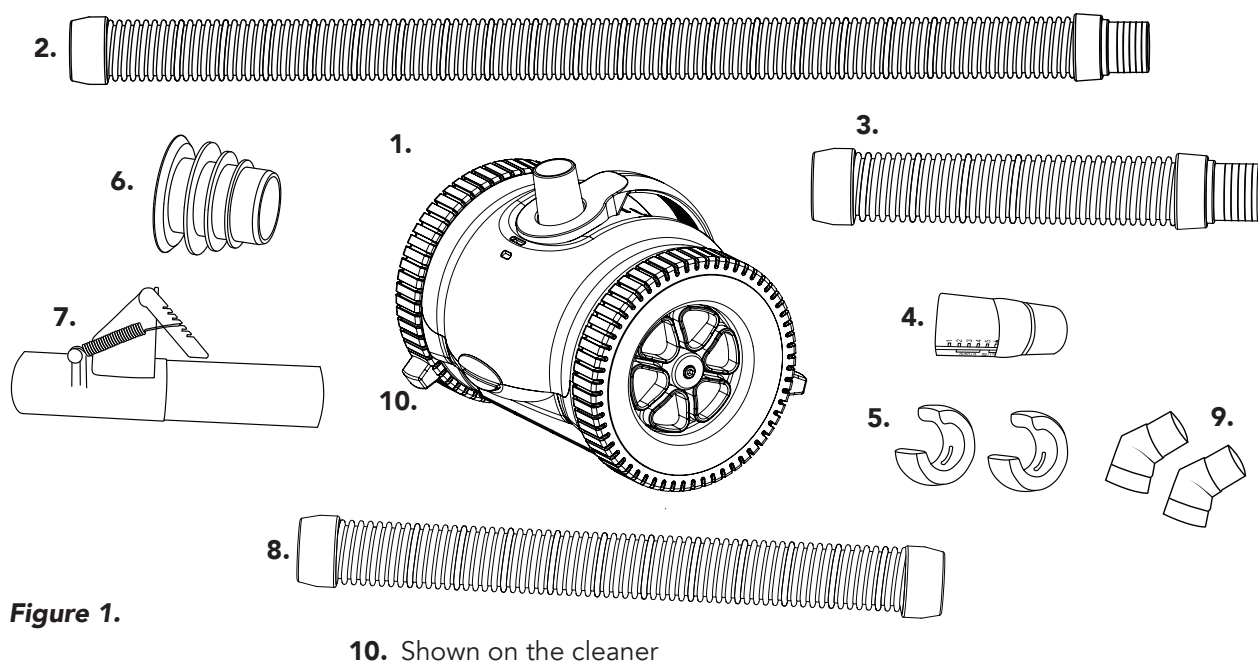

Figure 1.

10. Shown on the cleaner

STEP 2: CONNECT HOSES AND HOSE FLOAT

1. Assemble **Hose Sections** by pushing the male (smaller) **Hose Cuff** into the female (larger) **Hose Cuff** as shown in **Figure 2**.

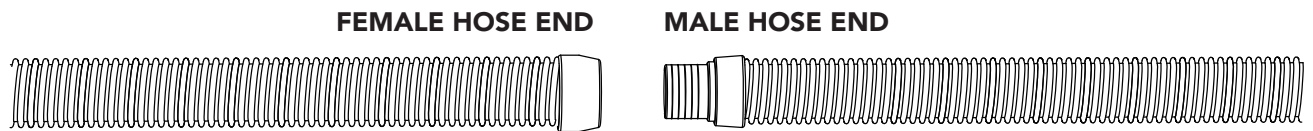

Figure 2.

2. Connect the female cuff of the leader (shorter, softer) hose to **Glide's** articulating swivel (on the top of the cleaner). See **Figure 3**.

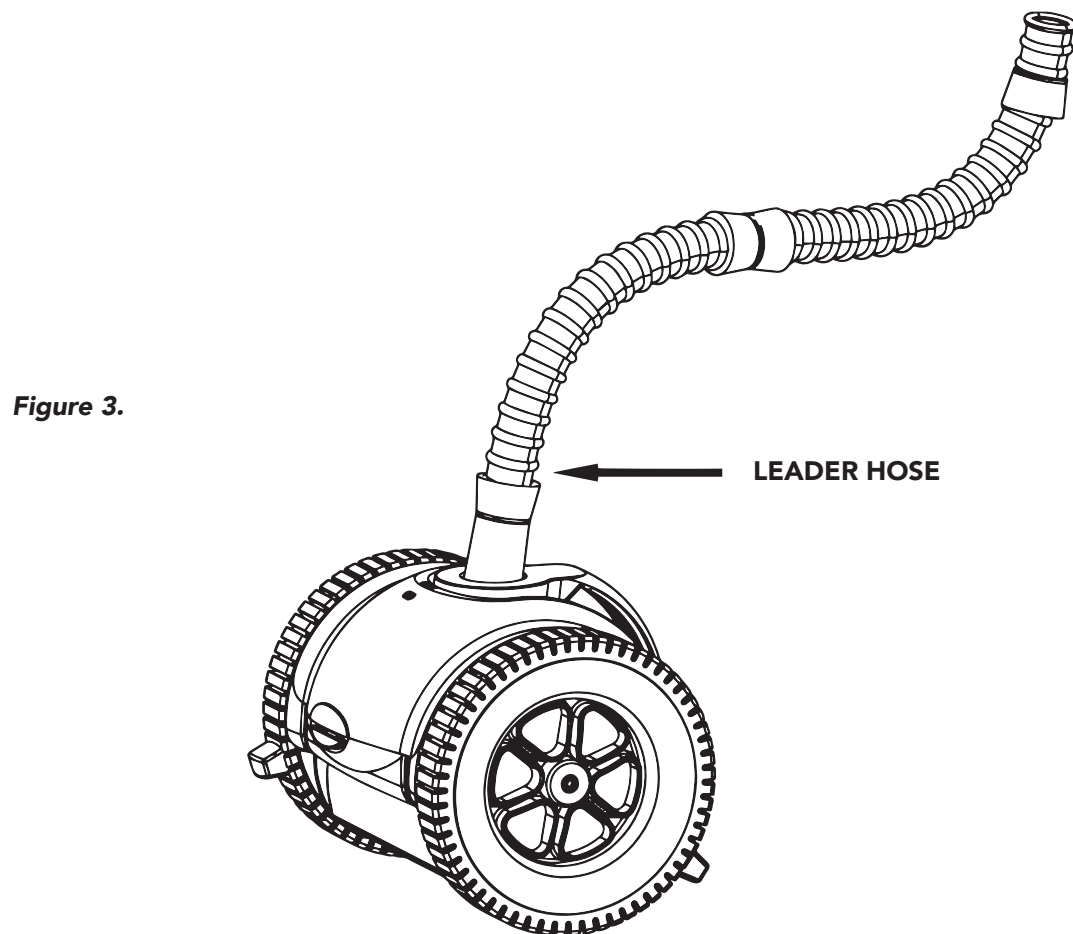

Figure 3.

HOSE FLOATS

The cleaner's hose floats are typically positioned as shown in **Figure 4**. The purpose of these floats is to maintain the cleaner in an upright position, preventing it from leaning too far forward or backward. Adjustments might be necessary at different suction levels to ensure the cleaner remains balanced.

The following combinations have proven to be most effective:

1. Position the first float **30cm** from the end of the leader hose and the second float **55cm** from the cleaner.
2. Position the first float directly on top of the cleaner (**0cm**) and the second float **70-80cm** from the cleaner, as shown in **Figure 4**.
3. Position the first float directly on top of the cleaner (**0cm**) and the second float **30cm** from the end of the leader hose.

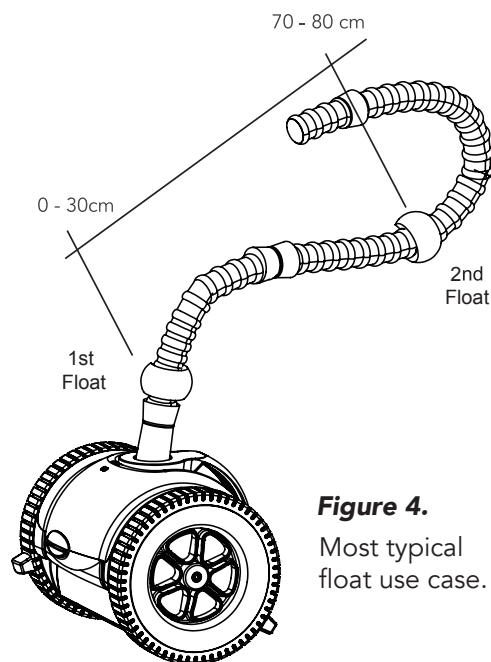

Figure 4.
Most typical float use case.

Note: To achieve wall climbing, the floats might need to be adjusted. If you are using the bumpers, it is unlikely the cleaner will climb the walls. It is best to aim for floor-only cleaning before attempting to climb walls.

4. Next, connect sufficient lengths of hose to cover the distance from the pool skimmer or vacuum point to the farthest point of your pool. See **Figure 5**.
5. Then add one extra length so you have enough hose to reach the farthest point of the pool plus the leader hose.
6. Next, connect the Last Female hose cuff to the male cuff of the leader hose. Keep the female to female hose last in the chain connecting to the skimmer box.

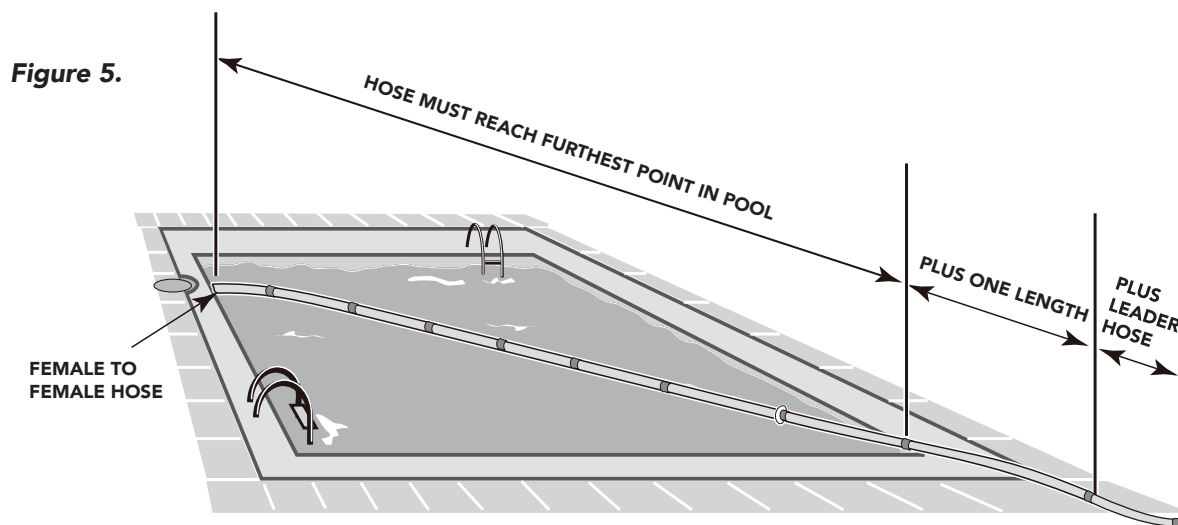

Figure 5.

STEP 3: INSTALLATION

WHEN CONNECTING TO THE POOL SKIMMER

When connecting to the skimmer box, the **Flow Regulator Valve (7)** must be used. This valve ensures the cleaner receives the required flow for optimum performance (see **Figure 7** for a typical setup of the skimmer plate).

1. Make sure the pump is turned **OFF**.
2. Remove all air from the hose.

Tip: To remove air from the pool cleaner hose, ensure the hose sections are tightly connected with the cleaner attached and in the water. Turn on the pool pump, hold the hose over a pool return line, wait briefly for air to escape through the cleaner, and keep the hose submerged to prevent air from re-entering. Then, turn off the pool pump.

3. Assemble the Elbows (9), Hose Cone (6), and Flow Regulator Valve (7) as shown in **Figure 7** below. The **Female/Female** hose should be the last hose coming from the cleaner and connects to the regulator valve. It will be a tight fit.

Note: The Flow Regulator Valve (7) has an arrow on the top. This arrow should point towards the pool/pool cleaner (away from the skimmer) and face the **Female/Female** hose.

4. The Flow Regulator Valve (7) automatically regulates the flow to the cleaner. If the flow from the pump is too high, the spring-loaded flap will open to bypass the excess, ensuring the correct amount of flow goes through the cleaner.

Note: The Flow Regulator Valve (7) comes preset between positions 3-4. If necessary, the valve can be adjusted using any setting from position 1-6 by changing the position of the springs.

- 1 = minimum flow to the cleaner, easy to open the spring-loaded flap.
- 6 = maximum flow to the cleaner, hardest to open the spring-loaded flap.

5. Turn the pump **ON**, and the **Glide** pool cleaner will begin to automatically vacuum your pool.

Note: The cleaner should operate between 11-14 RPM for optimal cleaning results.

Figure 6.

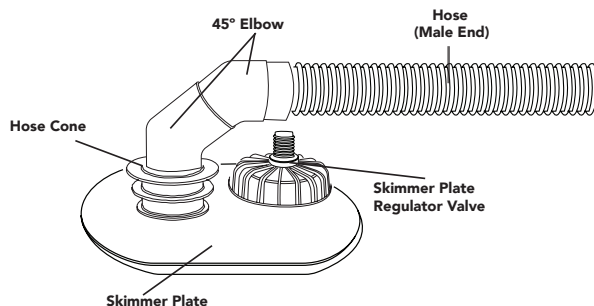
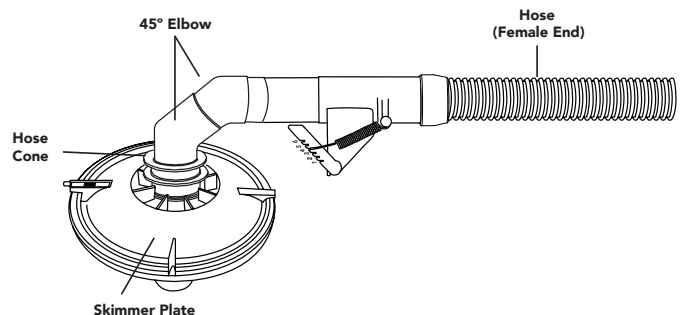

Figure 7.



***Note Figure 6:** If using a vacuum /skimmer plate with an integrated flow valve, you don't need the **Flow Regulator Valve (7)** or the **Female/Female** hose. The male end of the hose will fit into the elbow as shown.

WHEN CONNECTING TO A DEDICATED VACUUM LINE IN THE POOL

Some pools are equipped with a dedicated vacuum line, which allows the cleaner to be connected to this line. In such cases, the **Flow Control Valve** should **NOT BE USED**.

To connect to the dedicated vacuum line:

1. Make sure the pool pump is turned **OFF**.
2. Remove all the air from the pool cleaner and hose (see tip on page 9). This may require you to turn the pool pump **ON**. If so, make sure it is turned **OFF** before going to the next step.
3. Open the spring-loaded flap on the vacuum line wall fitting and insert the male (smaller) open end of the hose. Ensure it is well secured.
4. If more or less flow is required, adjust valves at pool pad as needed.



SAFETY INSTRUCTION

When using a dedicated vacuum line, make sure it is fitted with a safety vacuum lock. This will help prevent suction entrapment accidents. Contact your pool builder or retail pool professional for details.

FINE TUNING THE CLEANER

Your Cleaner comes preset, but once it's in the pool you need to adjust the wheel Revolutions Per Minute (RPM). The optimal RPM for your Glide pool Cleaner is between 11 and 14.

Note: The Glide pool cleaner will still clean your pool at lower RPMs, but it may struggle to move around corners and steps.

1. While your cleaner is running, bring it just beneath the surface of the pool water.
Note: Keep the cleaner below the surface to prevent it from sucking air. For safety, do this step at the shallow end of the pool with the pump operating.
- a. If connected to the skimmer, first remove the cleaner via the leader hose, then insert the flow-meter (4) (see **Figures 9, 9a, 9b** on page 12) into the female end. After 60 seconds and flow stability (pump has primed), check if the flow gauge dial registers Ground or Wall and what number.
Hy-Clor Recommends a flow of between 3-4.
Adjust the flow control valve springs in the skimmer box until the desired setting is reached. Remove the flow-meter and remount the cleaner. The Regulator Valve (7) is typically set between positions 3 and 4 for optimal pool flow. You can adjust the flow from Position 1 (**slowest**) to Position 6 (**fastest**), with Position 6 being closest to the body and Position 1 furthest away.
- b. If connected to a dedicated vacuum line, adjust valves at the pool pump area as needed.



SAFETY REMINDER

Keep all body parts away from the suction port.

Note: The Glide pool cleaner has a few different turning cycles, allow up to 5 - 10 min for the cleaner to turn out of difficult spots before changing the settings. The Glide is designed to clean the entire pool over 6+ hours using a random pattern.

RETURN EYEBALL POSITIONS

Position the return eyeballs to redirect the return water from the pool pump/filter system so it does not interfere with the Glides movement. Try different positions to see which works best in your pool:

- Flow directed alongside the pool (the tile line).
- Flow directed downward.
- Flow directed against the hose will help steer the cleaner away from obstructions such as stairs/ladder or corners.

Figure 8.

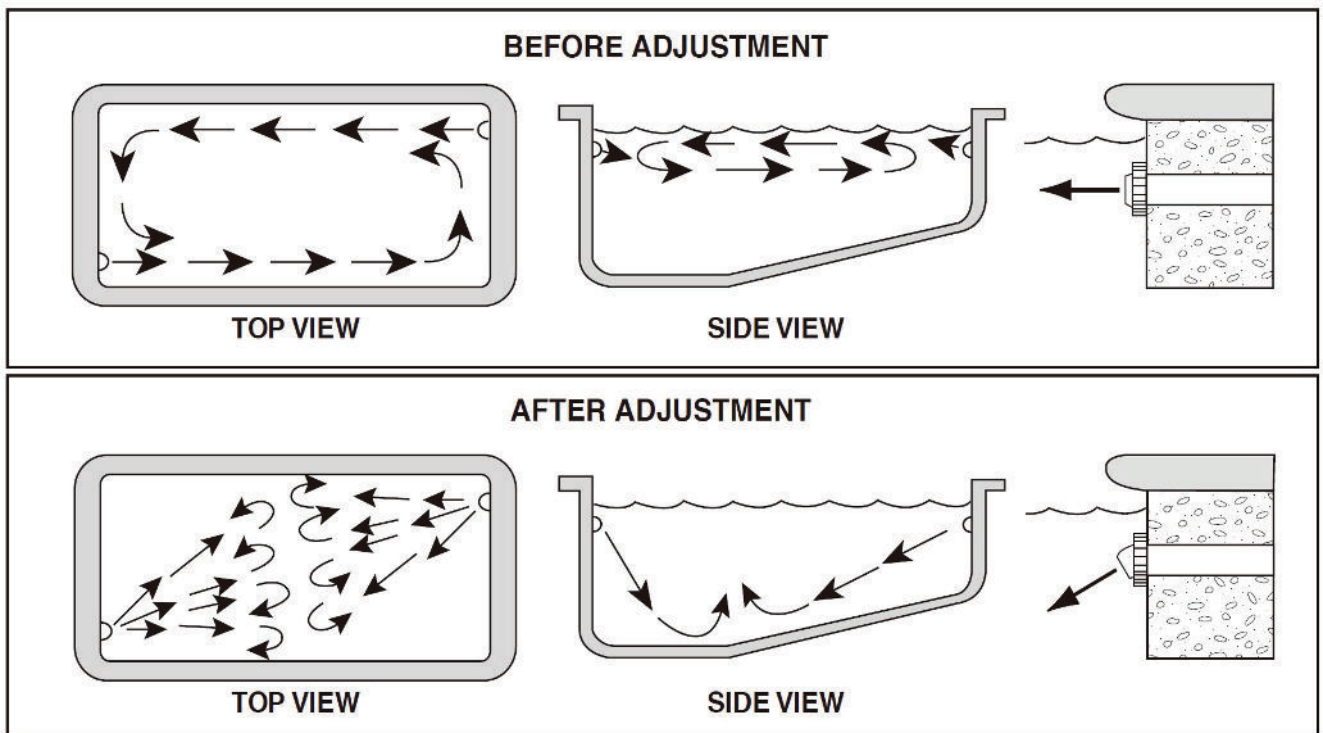

IMPORTANT: The Water flow from your return line can push your cleaner's hose and affect its performance. It may cause your cleaner to get stuck or push it away from areas you would like cleaned. (see Figure 8)

HOW TO USE THE FLOW-METER:

See page 10 (Fine tuning the cleaner)

Figure 9.

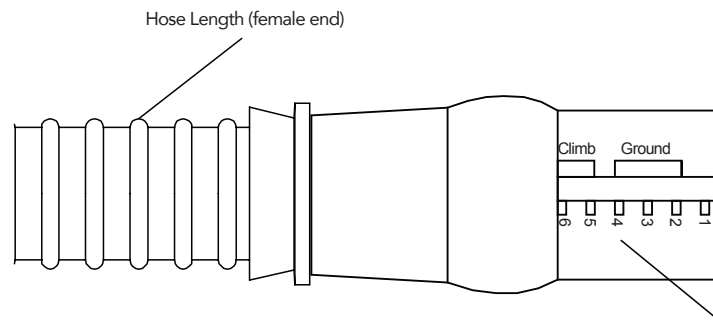

Aim for a flow of 4 for optimal performance.

Figure 9a.

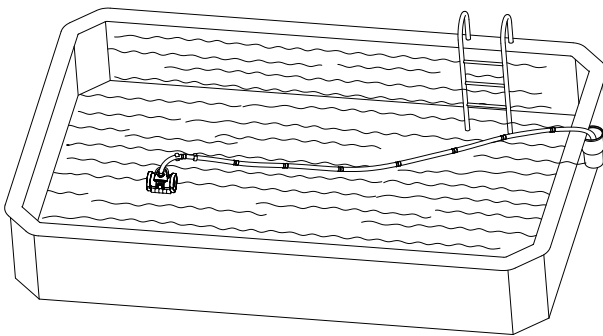

When the control valve flow is adjusted to ground the cleaner will not climb walls reliably - Hy-clor recommends number 4

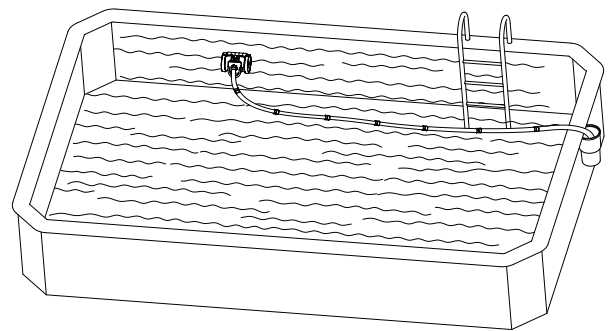

When the control valve flow is adjusted to the wall area marked by the flow-meter it may climb the walls.

Note: The cleaner is not designed to climb walls on fiberglass and Liner based pools. The bumpers will affect its climbing ability.

ROUTINE MAINTENANCE

To maintain the performance of your Glide pool cleaner:

- When removed from the pool, make sure the hose is stored straight. Never coil the hose as this may cause the hose to develop a "memory" which may adversely affect the performance of your your Glide pool cleaner.
- Remove your Glide (including hose) before chemical treatment. Wait a minimum of 24-48 hours hours after super chlorination (shock treatment) before re-installing the Glide pool cleaner.
- Clean the filter, skimmer basket and pump basket regularly.
- Periodically check your **Glide** for signs of wear. If necessary, replace any worn parts.

Note: Due to the harsh conditions in which your cleaner operates, its colour may fade or dull over time.

High Chlorine levels also cause wear and tear on the GLIDE pool cleaner and will break down the tyres. Ideal Chlorine levels are between 2-3ppm and a PH of 7.4

CARING FOR YOUR GLIDE POOL CLEANER

IF GLIDE STOPS RUNNING

1. Make sure the pool pump is off. Remove your Glide pool cleaner from the pool and disconnect the cleaner from the hose.
2. If you try to rotate the wheels and they don't move, check if anything is clogged inside the cleaner.

To open:

- a. Place Glide on a flat surface and gently loosen the buttons on the front side of the cleaner to free the cover as shown in Figure 10.
- b. Remove the **Cover** of your cleaner.
- c. Next remove the **Shroud** by placing a screwdriver under the small clip that holds it in place. Gently turn until **Shroud** can be removed.
- d. Remove any debris that is present around the gears and turbine.
- e. Reverse the process to reassemble your Glide pool cleaner.

Figure 10.

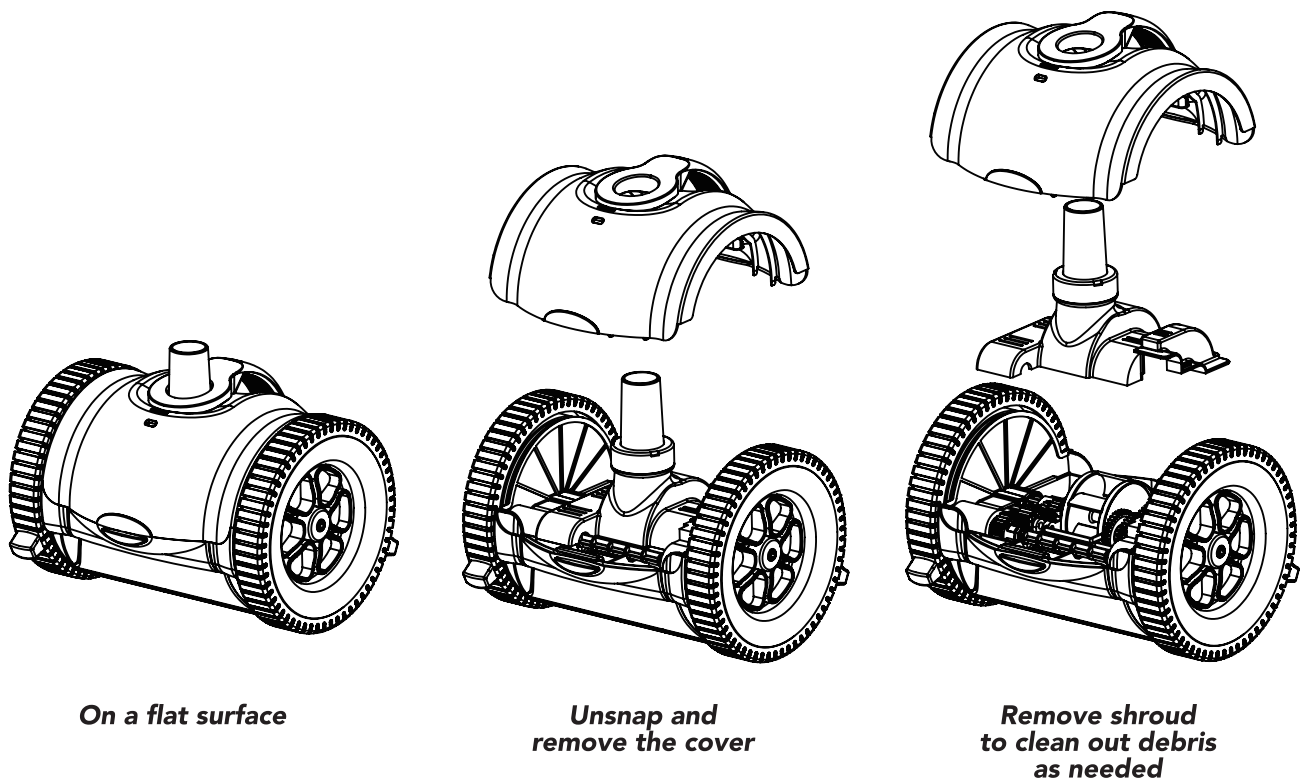

USING THE BUMPERS - IF REQUIRED

If the cleaner is getting stuck in the pool (usually in fiberglass pools or around main drains), using the bumpers is required. The bumpers help the cleaner push against walls or areas it needs to avoid in order turn.

It is best to use only one bumper and test it on the side causing the most issues (left or right). While the bumpers may affect the cleaner's wall climbing ability, it will still effectively clean the pool.

Trial and error will be necessary to find the best solution for your pool. You may also need to adjust the position of the floats.

The easiest way to install the bumpers correctly is to first remove the tyres, then insert the bumper through the tyre into the slot on the wheel, and turn to lock it in place. Finally, push the tyre back onto the wheel.

Figure 11.

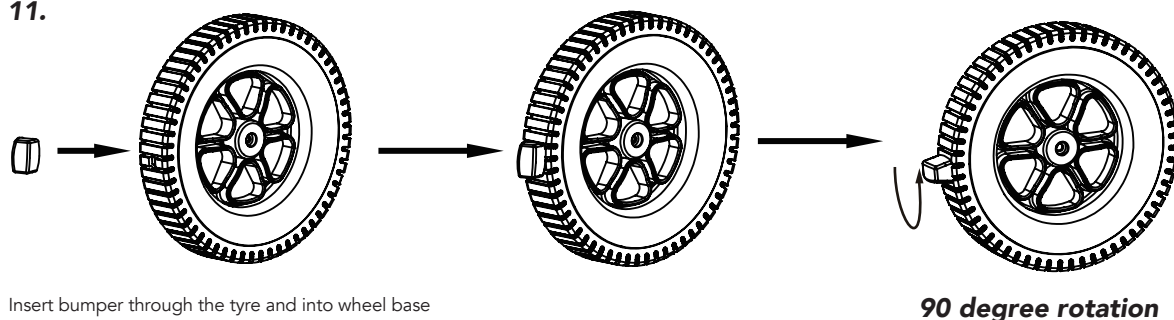

REPLACING TYRES

If your tyres are worn to the point where the indentations are barely visible or they are no longer able to gain traction, it is time to replace the tyres. Tyres can wear after prolonged use or from running Glide in a pool with a rough surface. See **Figure 12**.

Note: Using your Glide pool cleaner with worn tyres may damage the surface of the pool. The Tyre Bumper must be removed prior to replacing the tyres.

To change the tires on your cleaner:

1. Turn the pool pump off and remove Glide from the pool.
2. Disconnect the cleaner from the hose.
3. Place Glide on a flat work surface and, gently pull the tyres out of the hub fram of the cleaner wheel unit it leaves the hub frame.
4. Put on new tyres.
5. Reverse the process to reassemble your Glide pool cleaner.

Figure 12.

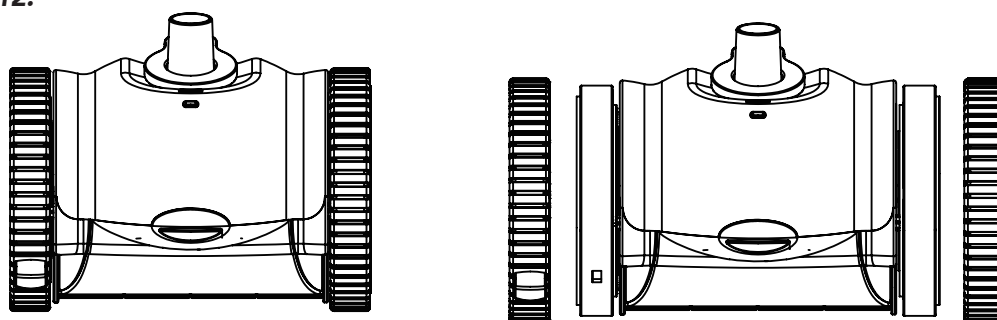

TROUBLESHOOTING

Due to the individual characteristics of your pool, some adjustment may be required to get the best performance from your Glide pool cleaner. The following tips will help you to optimise its performance.

Problem	Solution
<p>Glide does not move, or moves slowly.</p>	<p>Make sure the main drain is closed.</p> <p>Clean pool filter and empty pump strainer basket.</p> <p>Check the Flow control Valve and make sure Glide has sufficient flow.</p> <p>Adjust flow via Flow control valve (7) in skimmer. Measure flow using the flow-meter and check if in desired range.</p> <p>Check the cleaner for blockages or debris stuck inside.</p> <p>If bubbles are appearing in the pool via the returns - could be sign of leak consult a pool professional for advice.</p>
<p>Glide will not climb pool walls.</p>	<p>Increase flow to Glide</p> <p>Make sure hose float is in the correct position. (See Figure 4).</p> <p>NOTE: Glide's wall climbing ability may be limited in some pools. It is best to have the cleaner focus on the floor before aiming to climb walls.</p> <p>Make sure that the tyres are not excessively worn. See page 14. Tyres that are worn will not provide the traction necessary for your pool.</p> <p>Check whether the meter dial is in the marked wall climbing area. See page 12. Check to be sure the Leader Hose has been installed in the correct position.</p>
<p>Glide does not clean the entire pool or stays in one place.</p>	<p>Adjust/Use the Tyre Bumpers</p> <p>Use the flowmeter to measure whether the flow in the hose is at the required level. See page 12.</p> <p>Make sure the hose length is correct. See page 8.</p> <p>Make sure the hose float is in the correct position. See page 8. Check the return line flow and adjust if necessary.</p> <p>Aim the return eyeballs downwards or towards the area the cleaner is getting stuck.</p>

Problem	Solution
<p>Air bubbles are visible in return jets.</p>	<p>Check the hose to ensure there are no leaks.</p> <p>Check the connection of the Flow Control Valve to make sure it is under the water level.</p> <p>Check that pump basket lid is fitted correctly, is not loose or cracked and that no O-rings are worn or missing. If necessary, contact your pool professional for assistance.</p>
<p>Glide stays on the main drain.</p>	<p>Make sure the main drain is closed.</p> <p>Check to be sure main drain grate is installed.</p> <p>Fit one or both Tyre Bumpers to cleaner. See Page 14.</p>
<p>Glide climbs above the waterline and sucks air.</p>	<p>Make sure the hose float is in the correct position. See page 8.</p> <p>Use the flowmeter to measure if the flow in the hose is too high (see page 12), If it exceeds the demand, reduce the flow.</p>
<p>Hose won't fit Flow Control Valve.</p>	<p>Fit Hose Adaptor to Flow Control Valve.</p>
<p>Cleaner gets stuck or wedged on pool steps or other areas of pool.</p>	<p>Reduce suction to the cleaner, check the hose length and consider adding an additional hose. Check wheel RPM. Check tyre bumpers for wear, install one or both bumpers.</p>

GLIDE BREAKDOWN

No.	Name
1	Top cover
2	Handle
3	Swivel assembly
4	Turbine assembly
5	Gear assembly
6	Push button assembly (front and rear)
7	Wheel hub
8	Wheel axis
9	Tyre with bumper inserts
10	Tyre bumper
11	Decorative wheel hub insert
12	Wheel arch left
13	Wheel arch right
14	Flow gates
15	Body base
16	Cam shaft housing and assembly
17	Gear shaft assembly
18	Screws for handle
19	Leader hose
20	APC – Male/Female hose
21	APC – Female/Female hose

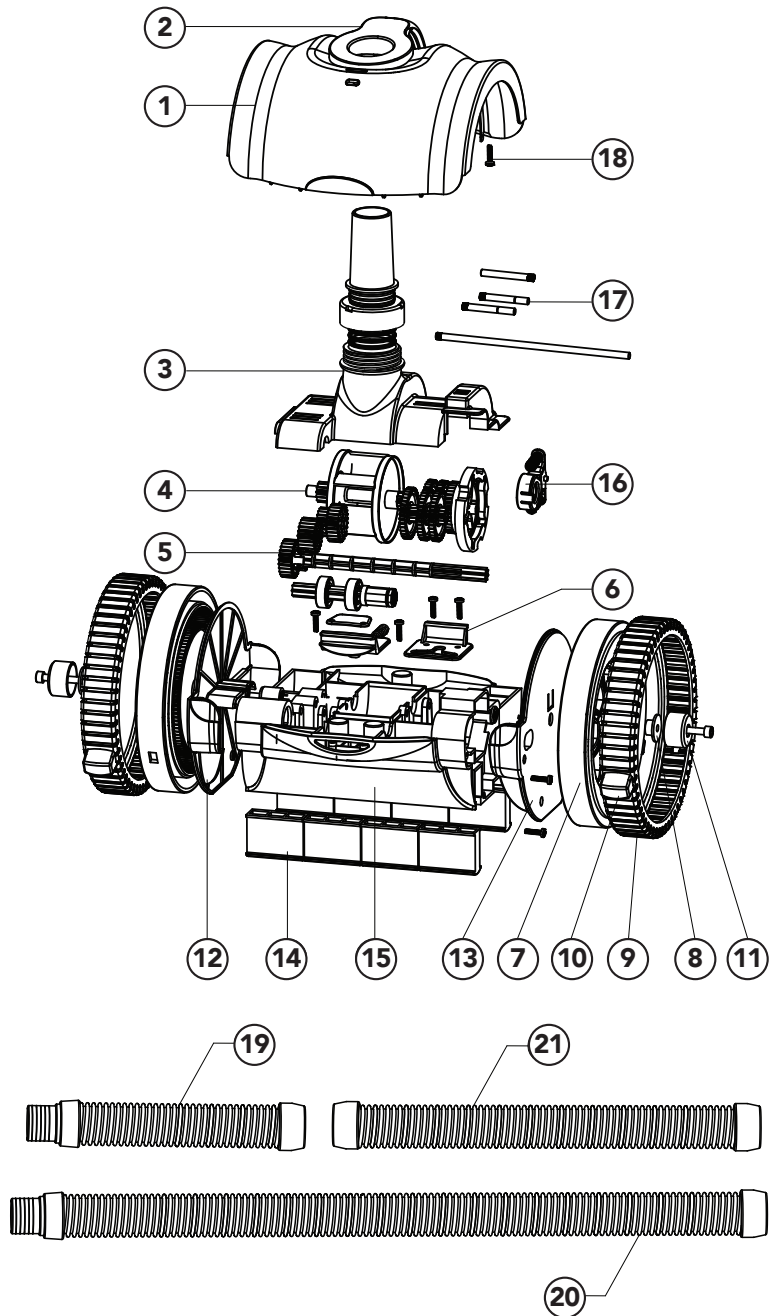

PRODUCT HELPLINE

AU: 1800 625 123
 NZ: (09) 973 2477

help@hyclor.com.au
 www.hyclor.com.au

GLIDE POOL CLEANER WARRANTY

WARRANTY TERMS AND CONDITIONS

Body/ Gears All other items - 1 Year
Tyres/ Hoses - 1 Year Limited warranty

Wear and tear parts are not covered under warranty. Tyres, flow guides, and bumpers have a limited 1-year warranty on construction only

Pool Chemistry and storage play major factors. Hyclor Reserves the right to make the decision on these items.

Before using the cleaner, review the owner's manual completely. Failure to read the owner's manual completely could result in pool damage caused by an improper installation of the cleaner. This warranty does not cover parts that are worn, scratched, faded as this is natural during normal operation in the pool. The warranty does not cover pools that are improperly maintained including water chemistry, pool surface construction and equipment failures. Pool plaster or vinyl damage is not covered under warranty of the cleaner. Misuse of the cleaner in any form is not covered including accidental misuse, acts of God.

Our goods come with guarantees that cannot be excluded under the Australian Consumer Law. You are entitled to a replacement or a refund for a major failure and for compensation for any other reasonably foreseeable loss or damage.

Please read these warranty terms and conditions carefully. A failure to comply with these terms and conditions may affect any claim on warranty you may have on a product.

WARRANTY GENERAL CONDITIONS

All products provided by HY-CLOR AUSTRALIA PTY LTD are warranted for defined periods of time (refer to product table).

All mechanical swimming pool products supplied to consumers by HY-CLOR are to be installed or used in the manner they are manufactured for only.

Warranty may be voided if the product or products claimed by the consumer under warranty have been used for purposes other than their designed or manufactured purpose.

Where applicable, products supplied by HY-CLOR come with operation and installation manuals. All care must be taken to install and operate the products according to these instructions. Failure to install or operate these products in accordance with these instructions may void warranty.

The chemical balance of the swimming pool water plays a significant part in the operational life of all swimming pool products, HY-CLOR recommends regular water testing using an approved swimming pool test kit.

This warranty is valid for the original purchase and is not transferable. Keep your purchase docket, tax invoice or receipt as the proof of purchase, and as proof of the date on which the purchase was made.

Modifications to any electrical product provided by HY-CLOR products are covered by a twelve-month warranty unless prior written approval has been granted by HY-CLOR and has been carried out by one of its authorized agents. All electrical installations must be carried out by a competent licensed professional.

All pool filtration equipment including filters, pumps and salt chlorinators, must be kept in a dry well ventilated area away from direct sunlight and in an area that is free from flooding or rain. This warranty does not cover normal wear and tear to the products or parts.

To make a claim please contact:

HY-CLOR AUSTRALIA PTY LTD
178 POWER STREET
GLENDEENING NSW 2761

FREE CALL NUMBER 5 DAYS A WEEK
1800 625 123.

PRODUCT HELPLINE

**AU: 1800 625 123
NZ: (09) 973 2477**

**help@hyclor.com.au
www.hyclor.com.au**



HY-CLOR AUSTRALIA PTY LTD
ABN: 81 000655 381

178 Power Street
Glendenning, NSW 2761 Australia

Australia: 1800 625 123
New Zealand: (09) 973 2477

help@hyclor.com.au
www.hyclor.com.au