



PULSE

AUTOMATIC POOL CLEANER

All pool cleaners require correct assembly and adjustment to work effectively. Do not return this cleaner to store before calling AUS 1800 625 123 NZ 09 973 2477 for assistance.

WARRANTY

This Product comes with a 1 year (twelve months) warranty from date of purchase. The warranty covers faulty workmanship only and does not cover misuse, abuse or normal wear and tear as a result of its operation. This product is not suitable for above ground and/or vinyl lined pools. Use in these types of pools and surfaces will void the warranty. The manufacturer takes no responsibility for damage to the pool and equipment should you choose to use this cleaner in an above ground and/or vinyl lined pool. Proof of purchase documentation such as the sales receipt is required when making an application for a warranty claim.

CARTON CONTENTS:

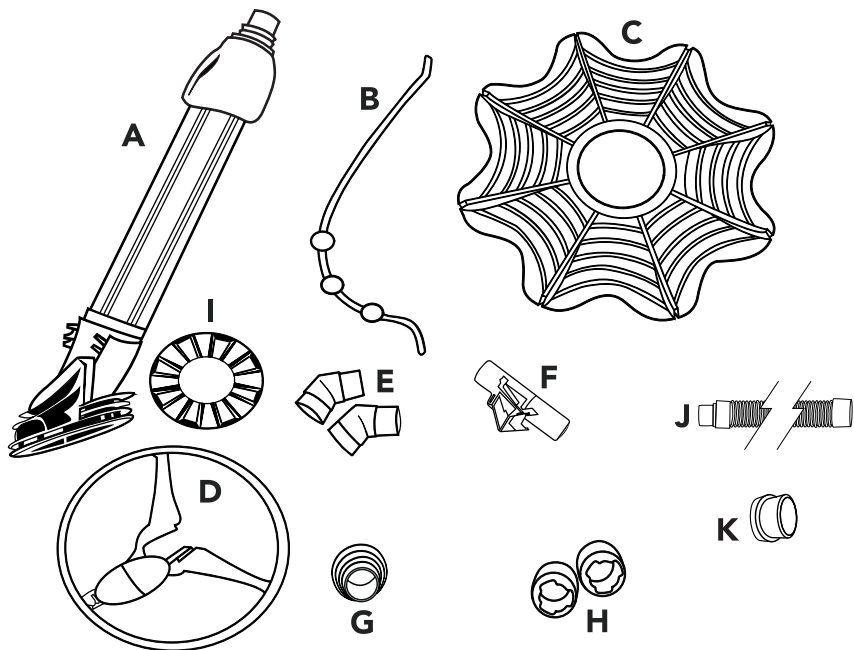

- A** -1x COMPLETE BODY
- B** -1x REAR BUMPER STRAP
- C** -1x PULSE SKIRT
- D** -1x DEFLECTOR WHEEL WITH DIVE FLOAT
- E** -2x 45° ELBOWS
- F** -1x REGULATOR VALVE
- G** -1x HOSE CONE
- H** -2x HOSE WEIGHTS
- I** -1x FOOTPAD
- J** -10x M/F 1M HOSES
- K** -2x HOSE ADAPTORS

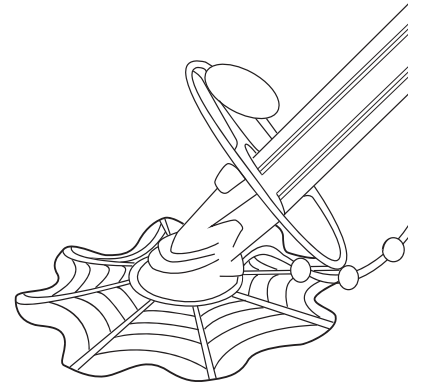

1

Fit the Hose Adaptor to the end of the cleaner body.

2

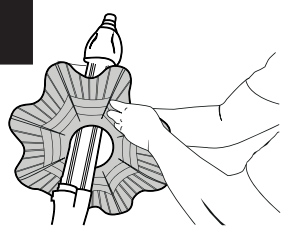

Slide the **SKIRT** over the cleaner body. Ensure that the **SKIRT** is in the upright position. The **SKIRT** has an indicator printed on it (TOP).

3

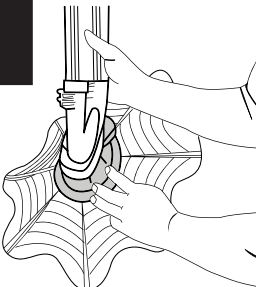

Twist or turn the **SKIRT** until it sits securely into the recess of the cleaner body base.

4

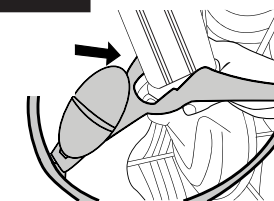

Clip the deflector wheel onto the rotating swivel. Push firmly onto the swivel until it locks into place.

5

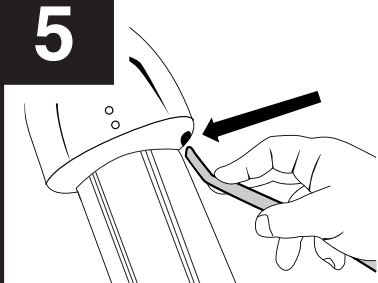

Clip the rear bumper strap into the top body slot. Ensure that the strap locks firmly into the slot.

6

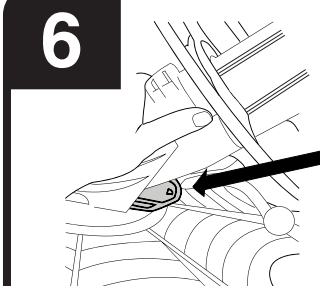

Clip the rear bumper strap into the base body slot. Ensure that the strap locks firmly into the slot.

7



1. Note the rear bumper strap position, the lead weights are at its base.
2. The deflector wheel should move on its swivel from left to right.

8

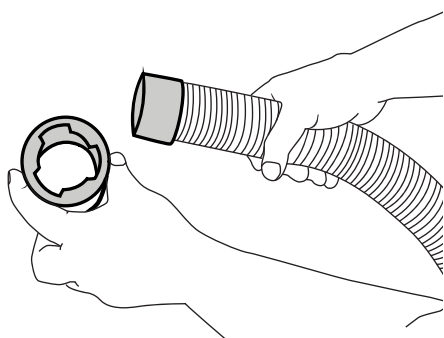

Two hose weights are provided. Most installations only require 1 hose weight. Position the hose weight at the end of the first hose section attached to the main body.

9

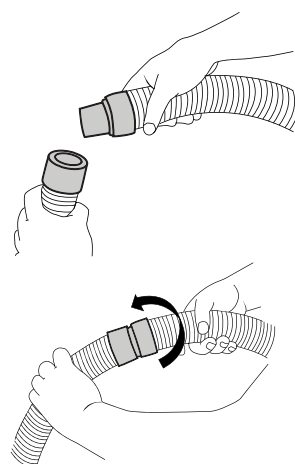

Place the cleaner at the furthest point from the skimmer box and fit enough hoses for the cleaner to reach the skimmer box.

Then add an additional length of hose to ensure cleaner will climb wall at furthestmost point of the pool.

HY-CLOR AUSTRALIA PTY LIMITED ABN: 81 000 655 381
178 Power Street, Glendenning NSW 2761 Australia

help@hyclor.com.au | All Australian enquiries 1800 625 123 | All New Zealand enquiries 09 973 2477

10

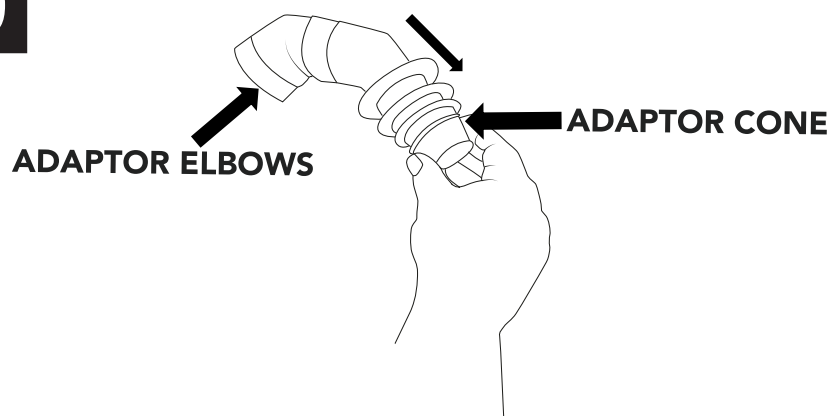

Connect the **ADAPTOR ELBOWS** to the **ADAPTOR CONE** as shown. Ensure a firm tight fit.

11

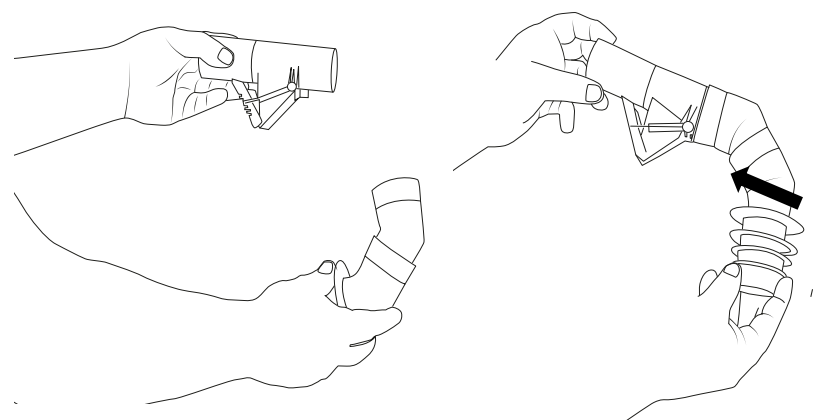

- Attach the **REGULATOR VALVE** to the **ELBOW AND CONE** assembly
- Turn off pool pump
- Ensure the skimmer box vacuum plate is fitted securely into the skimmer box
- Attach the **REGULATOR VALVE** (above)
- Place hose into the swimming pool and fill the hose with water
- Pass the cleaner hose through the mouth of the skimmer box and attach the end onto the **REGULATOR VALVE**. Ensure a tight fit
- Turn on pool pump and observe cleaner operation

12

Once the cleaner begins to vibrate and move along the floor of the pool it may be necessary to adjust the speed to ensure a thorough clean.

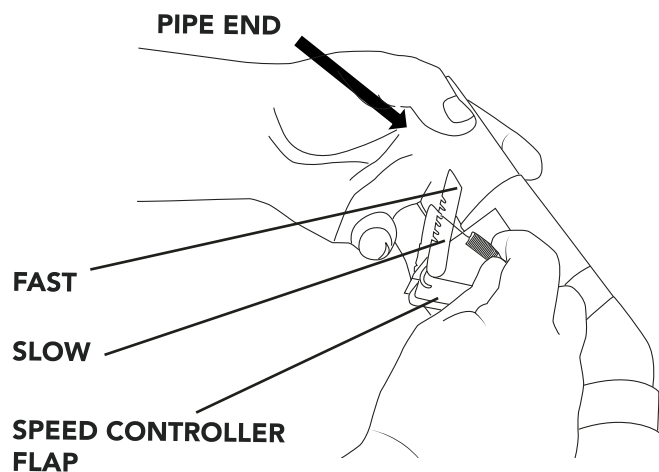

TO ADJUST THE SPEED OF THE POOL CLEANER

To increase the speed of the cleaner:

Increase the tension of the springs.
Firmly grasp the spring, lift and position closer towards the speed controller pipe end.

To reduce the speed of the cleaner:

Reduce the tension of the springs.
Firmly grasp the spring and move it towards the speed controller flap.
Both springs should be placed in matching positions on both sides of the speed controller. Refit the speed controller and restart the pump.

13

Position hose weights on 1st hose length approx 1 metre from cleaner head.

- TO BEGIN**
- | | |
|--|---|
| <p>CLEANER TIPS UP ON IT'S FRONT</p> <ul style="list-style-type: none"> • Move hose weight AWAY from the cleaner head. • Increase suction • Check hose length | <p>CLEANER TIPS BACK UP ON IT'S REAR</p> <ul style="list-style-type: none"> • Move weight towards the cleaner head • Check hose length |
|--|---|

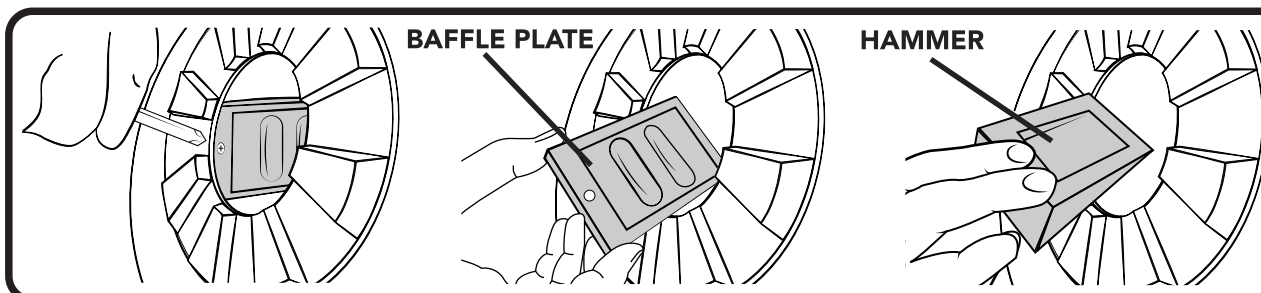
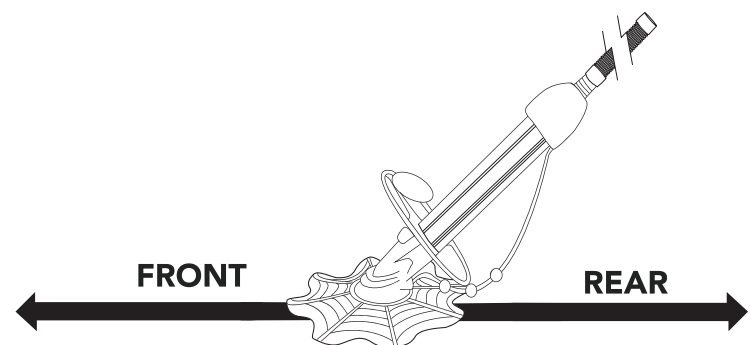

TO CLEAR BLOCKAGES

- Unscrew baffle plate and remove hammer
- Rinse with pool water or garden hose

TROUBLE SHOOTING

1. THE POOL CLEANER IS WORKING AT A SLOW PACE OR NOT MOVING AT ALL

- Check that pump is the correct size
- Ensure all air has been removed from the cleaner hose
- Ensure all hose joints are tight
- Adjust the speed control valve
- Check cleaner base for debris blocking the hose or hammer
- Check length of hose; is it too long?

2. THE CLEANER IS SUCKING AIR

- Adjust the speed controller
- Ensure the speed controller spring door is under water
- In the skimmer box
- Ensure hose joints are tight
- Ensure skimmer box vacuum plate is fitted correctly
- Ensure pool water level is correct

3. THE CLEANER IS DOING A REPETITIVE PATTERN OR CLIMBING THE WALLS ONLY

- Adjust the cleaner regulator valve to reduce speed
- Adjust the direction of the water flow from the pool wall eyeball returns down
- Add or remove hose lengths

4. POOL PUMP WON'T FILL WITH WATER

- Check for air leaks
- Re-seal pump lid
- Follow steps outlined in point two above
- Prime pump without cleaner, then turn off, reattach and start pump

GENERAL INFORMATION

The Automatic Pool Cleaner is designed to work in inground non vinyl lined swimming pools with a minimum 0.75 horse power (SOOW) pump and must have a fixed skimmer box with a vacuum plate. Before operation it is important to remove any large objects from the pool floor such as twigs, rocks, pool toys, goggles etc. to prevent the cleaner from jamming or becoming damaged. The pool cleaner will climb walls in most in-ground pools depending on the angle of the wall/floor and pool pump size. The pool cleaner runs in backwards direction and cleans the pool in a random pattern over a number of hours. Store cleaner out of direct sun-light when not in use.

CONTACT OUR FRIENDLY CUSTOMER SERVICE FOR GREAT ADVICE. FULL RANGE OF SPARES AVAILABLE.

CALL AUSTRALIA 1800 625 123 NEW ZEALAND 09 973 2477

HY-CLOR AUSTRALIA PTY LIMITED ABN: 81 000 655 381
178 Power Street, Glendenning NSW 2761 Australia

help@hyclor.com.au | All Australian enquiries 1800 625 123 | All New Zealand enquiries 09 973 2477